

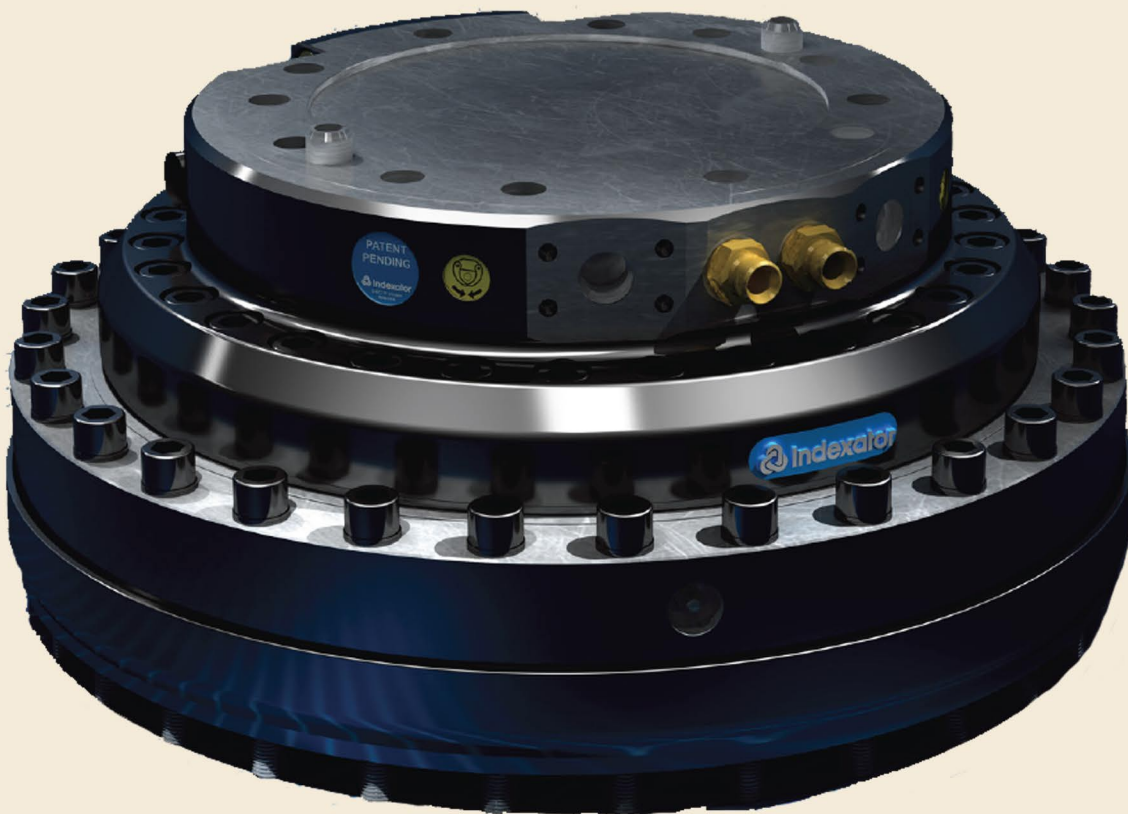

NORTH AMERICAN HYDRAULICS



XR Series Rotator



Motors • Pumps • Gearboxes • Valves • Controls • Power Units

 www.nahi.com

225-751-0500

NEW



XR-program ready for the market

Innovation and product development is a natural ingredient within Indexator Rotator Systems daily operations. Now the XR-program is launched for applications where extremely high demands are placed on rotator functionality.

The XR-program consists of compact and powerful rotators with strong bearings. Thanks to the proven vane motor technology the XR-rotators are high torque, have good compliance and also have balanced braking. Their compact and robust construction provides an ability to withstand heavy static and dynamic loads, both positive and negative forces as well as side forces. The XR-rotator provides high oil flow for grapple cylinders due to large channels – ensuring high productivity and overall economy.

With XR-rotators, you have a complete solution for heavy work within forestry, material handling, scrap handling, recycling and timber handling. The XR-program models also offer an extra channel for central lubrication.

XR-models ready for delivery

- XR 500
- XR 500 C
- XR 600
- XR 600 C

The XR-program will successively be extended with more models.

C = Central lubrication

Advantages with XR

- High torque
- Capable of handling heavy dynamic and static loads
- Mounted on grapple roof or on top of the harvester head
- High productivity and total economy
- Proven Vane Motor
- High swivel performance

Constant improvements

Our production is certified in accordance with regulations for quality, environment and working environment. Our employees combined abilities and whole-hearted commitment means that we can live up to our epithet of the quality factory“.



XR 500

Part No: 8500000

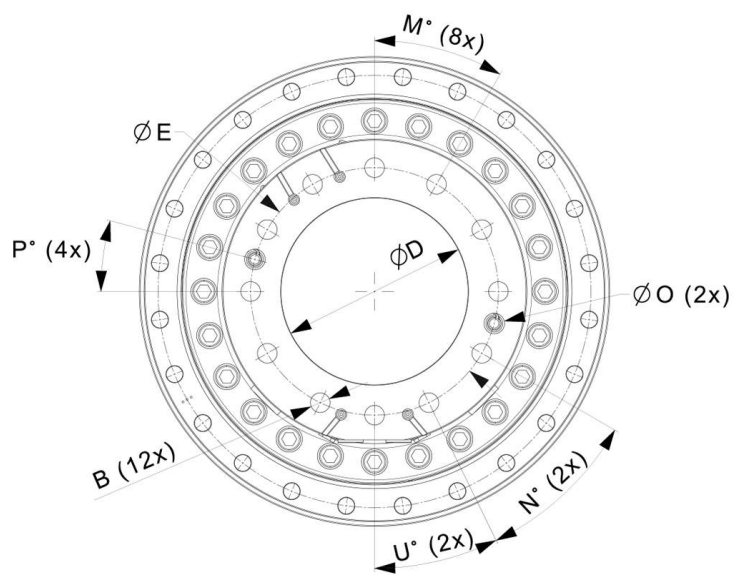
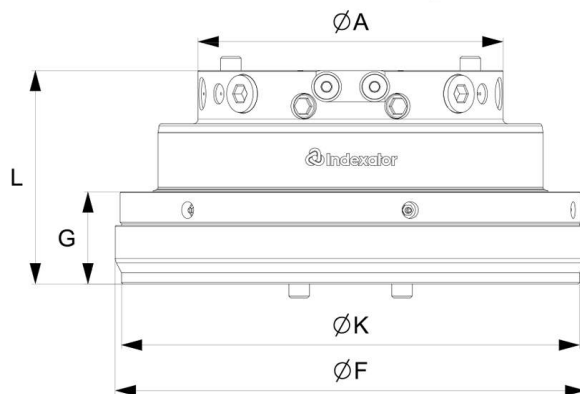
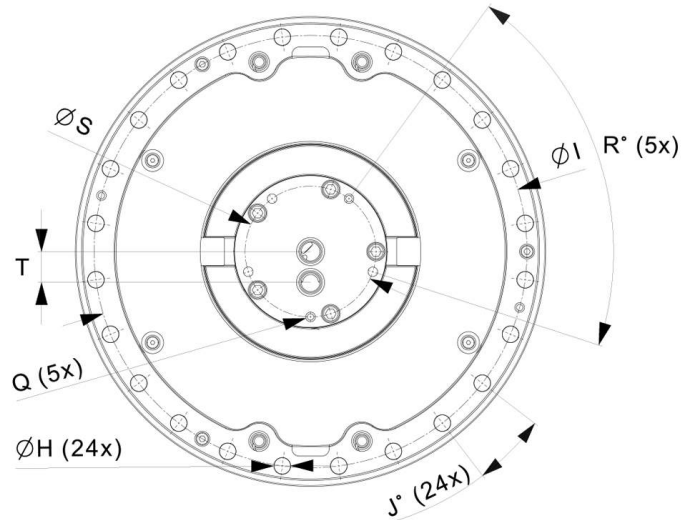
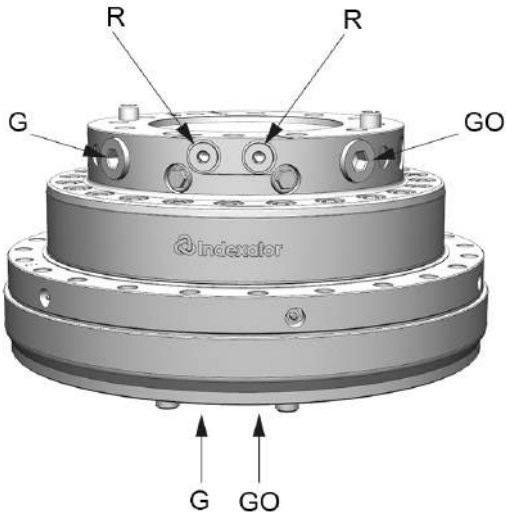

Technical data

		
216 kg	700 kN ¹	7000 Nm

Connections, max working pressure and max oilflow

R:	Connections: G 1/2 Max working pressure: 25 MPa Max oilflow: 65 l/min
G:	Connections: G 1 Max working pressure: 35 MPa
GO:	Connections: G 1 Max working pressure: 35 MPa

Measure specification

A: Ø326mm	B: M24	D: Ø200mm	E: Ø265mm
F: Ø503mm	G: 98,5mm	H: Ø18mm	I: Ø463mm
J: 15°	K: Ø490mm	L: 228,5mm	M: 30°
N: 34°	O: Ø22mm	P: 15°	Q: M12
R: 72°	S: Ø140mm	T: 33mm	U: 26°



¹ Max axial load static indicate theoretical max load for hanging applications without accelerations.

XR 500 C

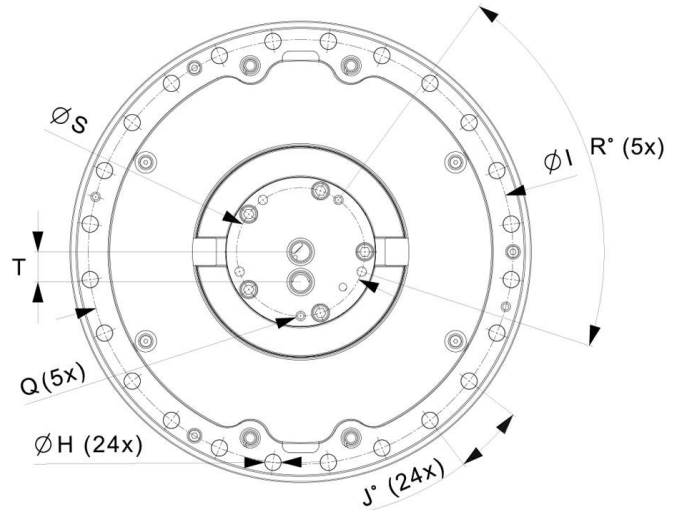
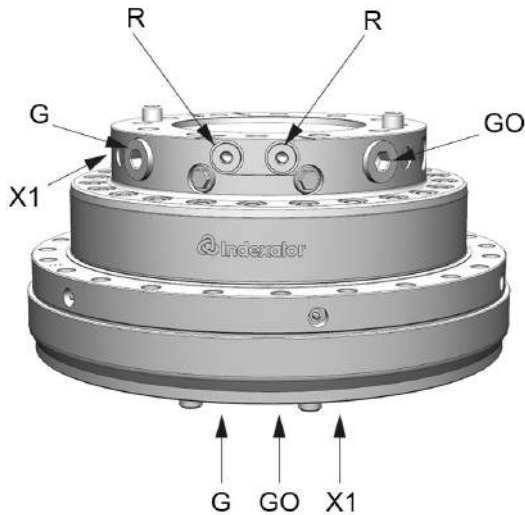
Part No: 8500001



Technical data

		
216 kg	700 kN ¹	7000 Nm

Connections, max working pressure and max oilflow

R:	Connections: G 1/2 Max working pressure: 25 MPa Max oilflow: 65 l/min
G:	Connections: G 1 Max working pressure: 35 MPa
GO:	Connections: G 1 Max working pressure: 35 MPa
X1:	Connections: M10x1,0 Max working pressure: 40 MPa

Measure specification

A: Ø326mm	B: M24	D: Ø200mm	E: Ø265mm
F: Ø503mm	G: 98,5mm	H: Ø18mm	I: Ø463mm
J: 15°	K: Ø490mm	L: 228,5mm	M: 30°
N: 34°	O: Ø22mm	P: 15°	Q: M12
R: 72°	S: Ø140mm	T: 33mm	U: 26°

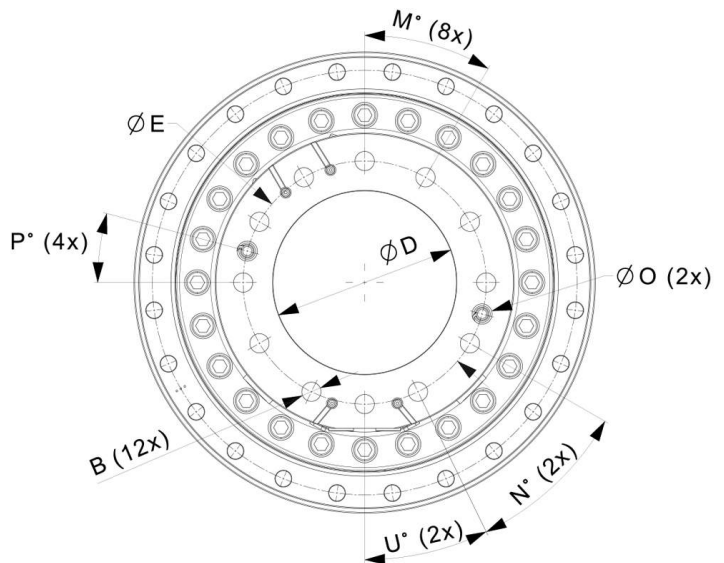
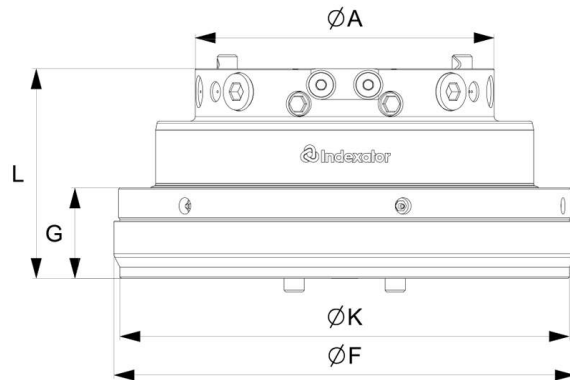



¹ Max axial load static indicate theoretical max load for hanging applications without accelerations.

XR 600

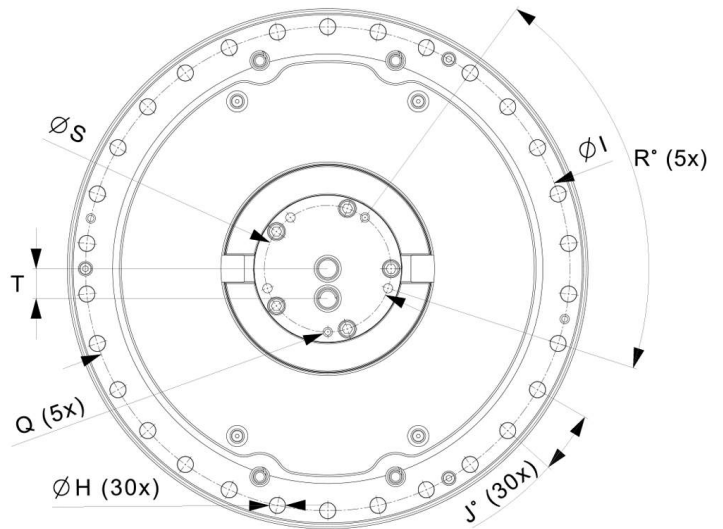
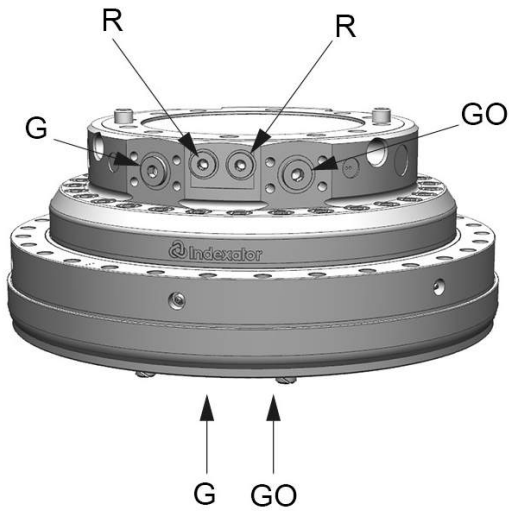
Part No: 8600000



Technical data

		
264 kg	850 kN ¹	7000 Nm

Connections, max working pressure and max oilflow

R:	Connections: G 1/2 Max working pressure: 25 MPa Max oilflow: 65 l/min
G:	Connections: SAE 6000 DN 25 Max working pressure: 35 MPa
GO:	Connections: SAE 6000 DN 25 Max working pressure: 35 MPa

Measure specification

A: Ø384mm	B: M24	D: Ø260mm	E: Ø300mm
F: Ø575mm	G: 103mm	H: Ø18mm	I: Ø535mm
J: 12°	K: Ø565mm	L: 231mm	M: 37°
N: 30°	O: Ø22mm	P: 12°	Q: M12
R: 72°	S: Ø140mm	T: 33mm	

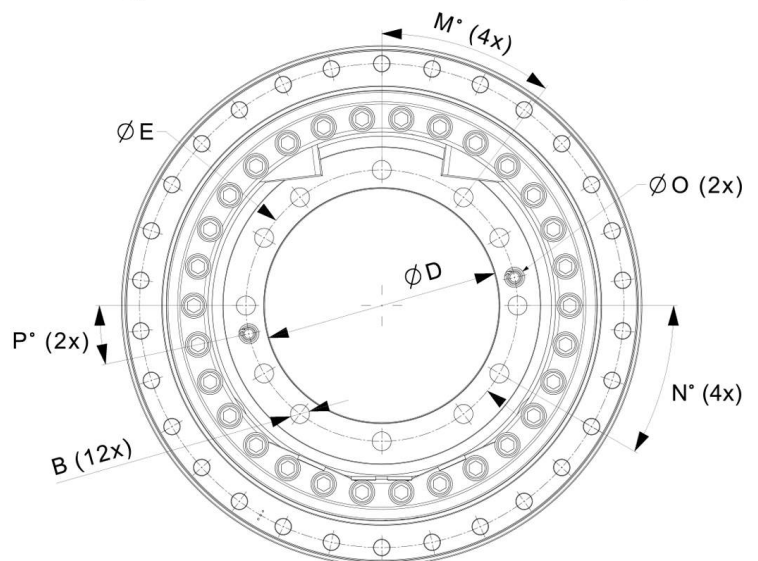
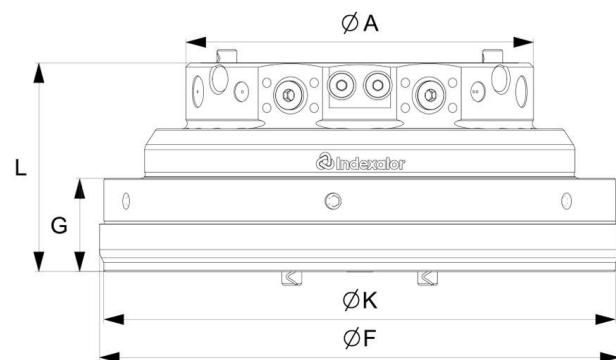



¹ Max axial load static indicate theoretical max load for hanging applications without accelerations.

XR 600 C

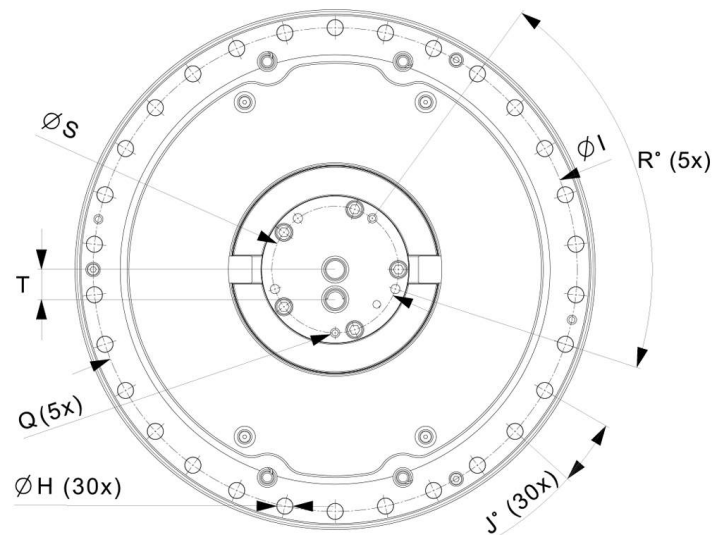
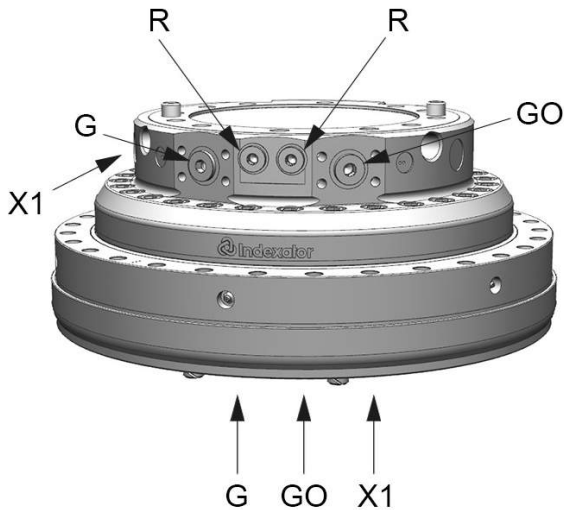
Part No: 8600001



Technical data

		
264 kg	850 kN ¹	7000 Nm

Connections, max working pressure and max oilflow

R:	Connections: G 1/2 Max working pressure: 25 MPa Max oilflow: 65 l/min
G:	Connections: SAE 6000 DN 25 Max working pressure: 35 MPa
GO:	Connections: SAE 6000 DN 25 Max working pressure: 35 MPa
X1:	Connections: M10x1,0 Max working pressure: 40 MPa

Measure specification

A: Ø384mm	B: M24	D: Ø260mm	E: Ø300mm
F: Ø575mm	G: 103mm	H: Ø18mm	I: Ø535mm
J: 12°	K: Ø565mm	L: 231mm	M: 37°
N: 30°	O: Ø22mm	P: 12°	Q: M12
R: 72°	S: Ø140mm	T: 33mm	

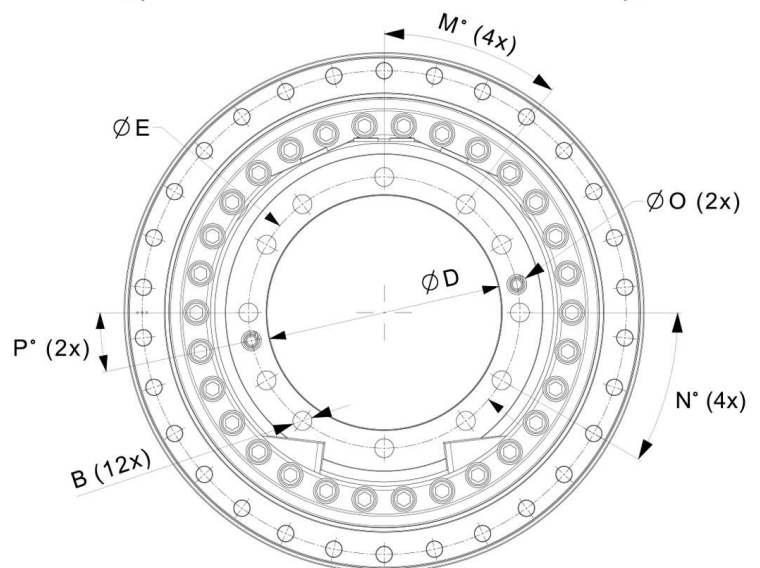
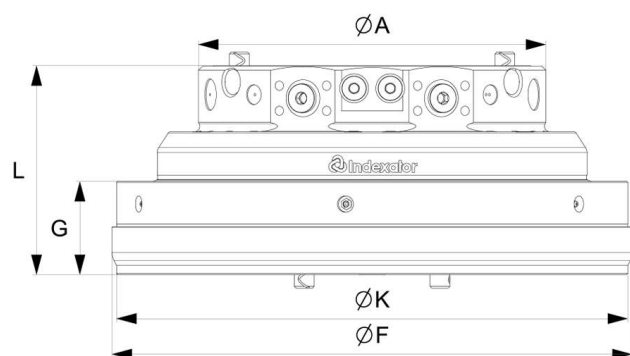

¹ Max axial load static indicate theoretical max load for hanging applications without accelerations.

XR ROTATORS

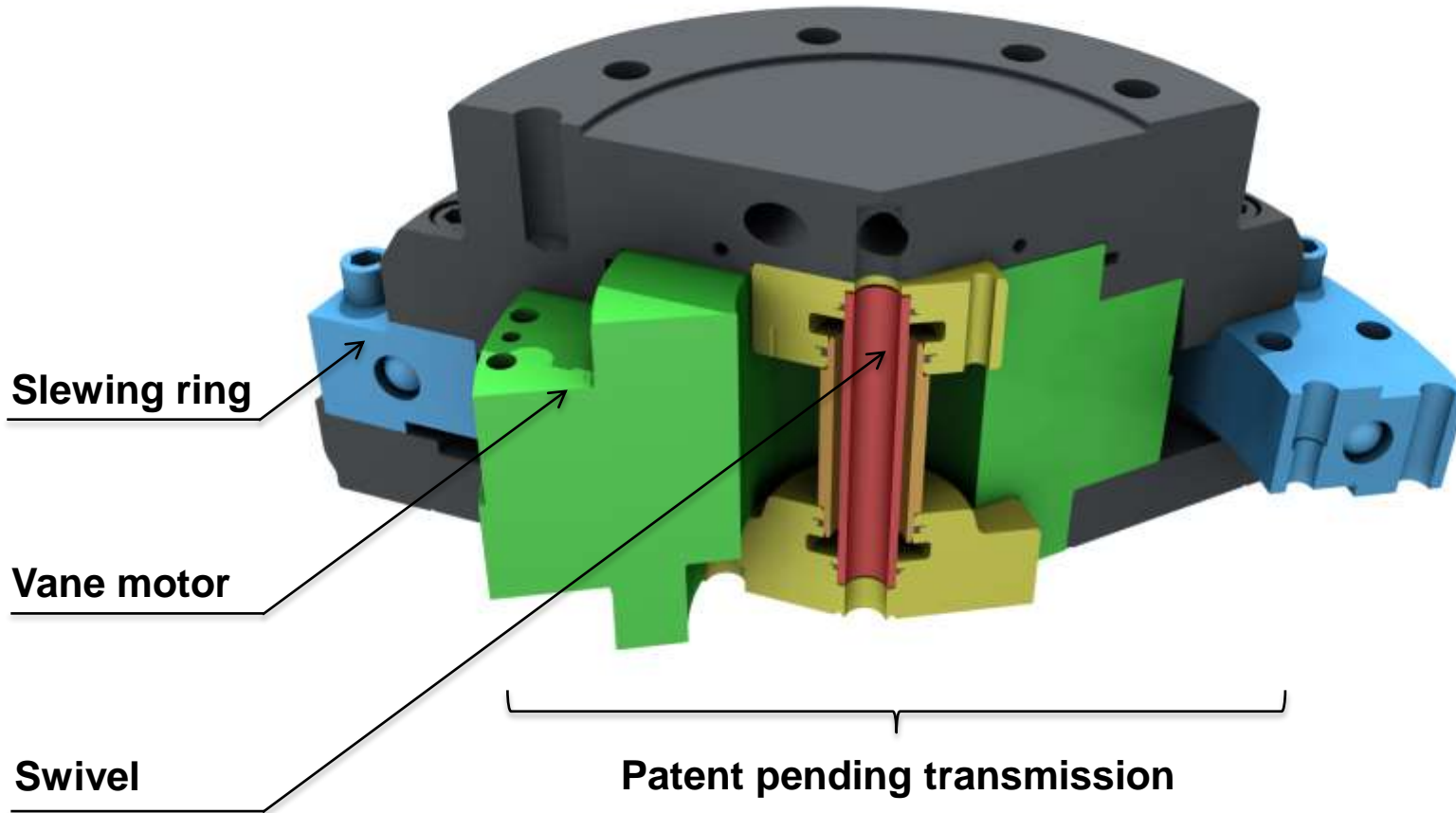

XR ROTATORS

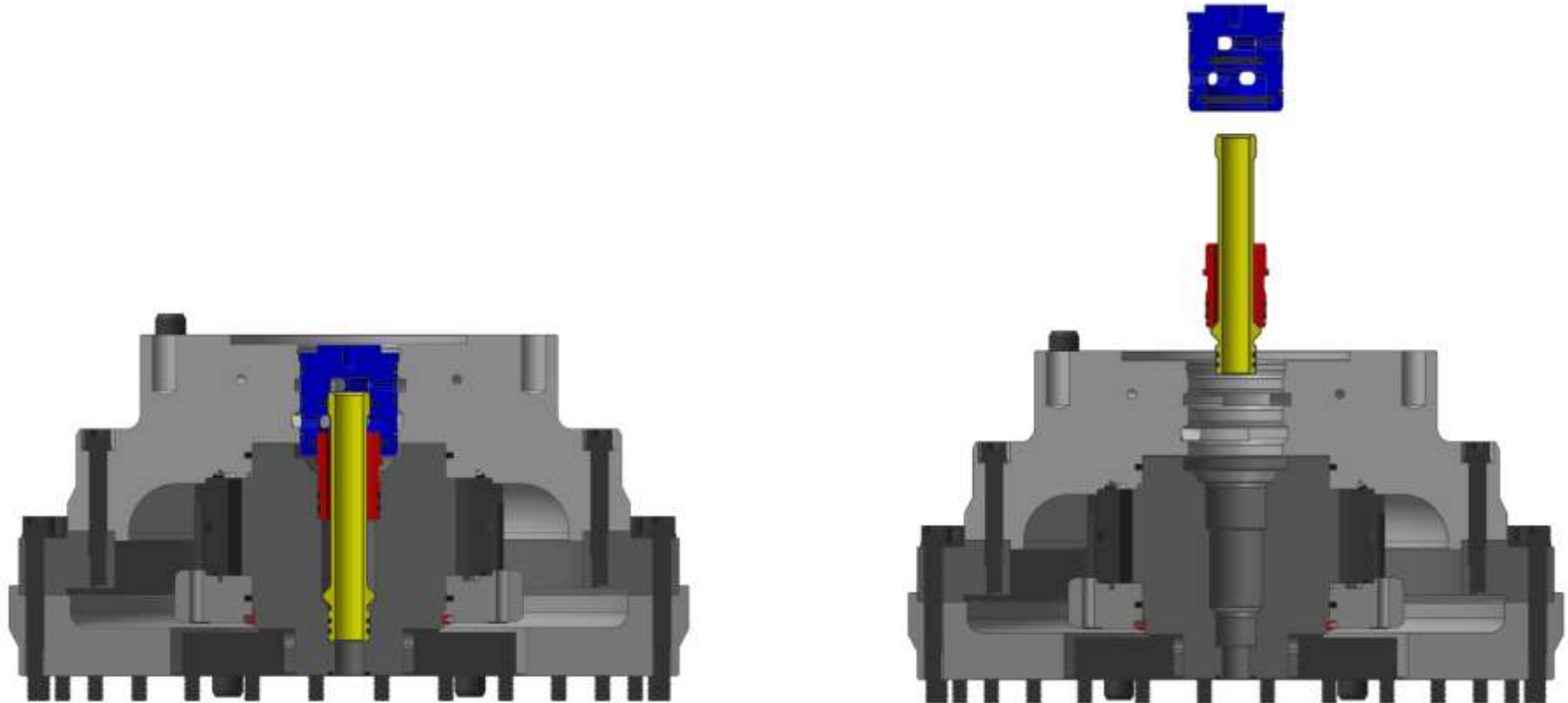

XR ROTATORS

Design flexibility

